

Bosworth Copaliner® Instructions for Use

Copaliner® protects the dentin and penetrates, fills, and seals the tubuli. It insulates against thermal, galvanic reaction and electrical shock. Copaliner's ability to provide a marginal seal between the dentin and amalgam helps to protect against penetration into the cavity of oral fluids, microorganisms and metallic ions from amalgam restorations. Its non-chloroform formula is virtually insoluble in the oral environment. Copaliner® is ether-based with a biologically mild formula, minimizing post-operative sensitivity. **COPALINER CAN ONLY BE USED UNDER AMALGAM.**

1



Completely prepare the cavity and isolate the tooth with a rubber dam or cotton rolls.

2



Thoroughly dry the dentin with compressed air.

3

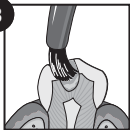

With a cotton pledget, applicator brush or sponge, apply sufficient amount of Copaliner to the prepared tooth site. Be sure not to flood area with material.

4

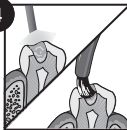

Sufficiently dry area with air syringe, if necessary repeat process and dry again. Saturation is indicated by a slight glossy appearance. It is advised that the preparation be coated one or two times with Copaliner or until a glossy appearance is achieved.

5

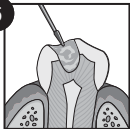

Once the final drying process is complete, insert filling or restorative material.

NOTES

1. To prevent possible cross-contamination, do not redip a used applicator back into the Copaliner bottle. If stray application has occurred, Varnish can be removed with a sharp blade instrument or Solvent. If the consistency of the Varnish appears to thicken and/or change color, the addition of Solvent will liquify and return the Varnish to its original color without affecting the physical properties.
2. Use Copaliner in a well ventilated area.
3. Copaliner bottles should be tightly capped when stored and do not require refrigeration.
4. Copaliner should not be used under composite, glass ionomer or resin restorations because it will interfere with the setting reaction.

CAUTION: Certain individuals may be sensitive to products containing copal resin.

See SDS for safe handling precautions and proper waste disposal. (www.keystoneindustries.com/en/msds)